

PLACE MOP HANDLE ABOVE COLLET

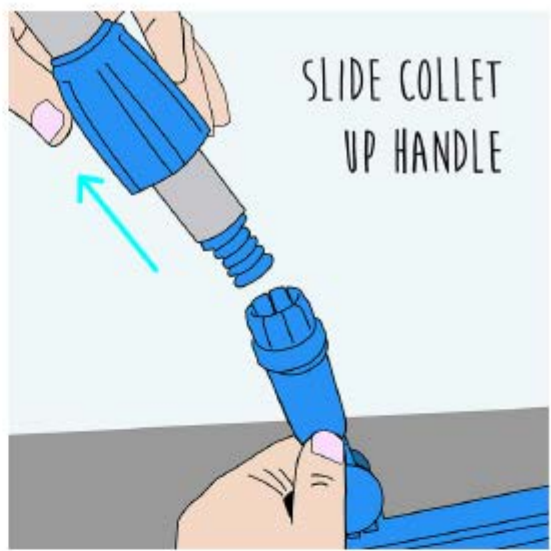

SLIDE COLLET UP HANDLE



INSERT HANDLE INTO FRAME

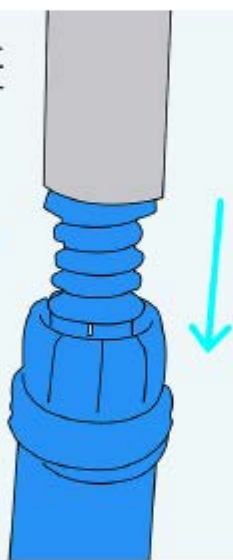

INSERT IT ALL THE WAY UNTIL IT SEATS (THE HANDLE DOESN'T THREAD INTO THE FRAME)

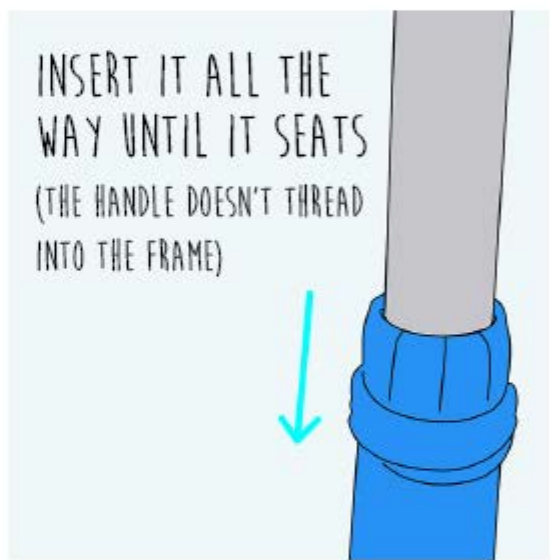

IF YOU HAVE TROUBLE GETTING THE HANDLE IN, TRY PRYING THE "FINGERS" ON THE FRAME APART



TURN TO LOCK INTO PLACE

